

1976 Individual House OSAKA CITY 360m²
Permanent collection of NEW YORK Modern art Museum

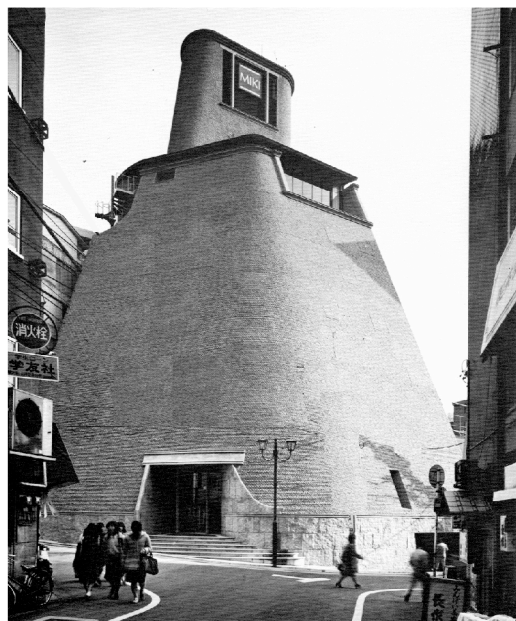

1977 LONGCHAMP BLD. KYOTO CITY 7,500m²
Permanent collection of NEW YORK Modern art Museum

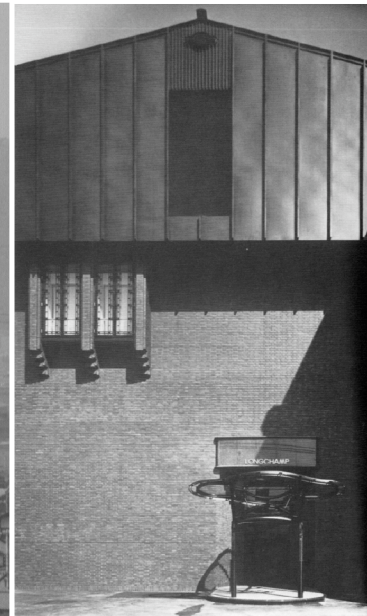

1985 MIKI CORPORATION TOKYO Office
TOKYO 2,300m²



1983 NAGASE CO.,LTD Main Office
OSAKA CITY 10,200m²

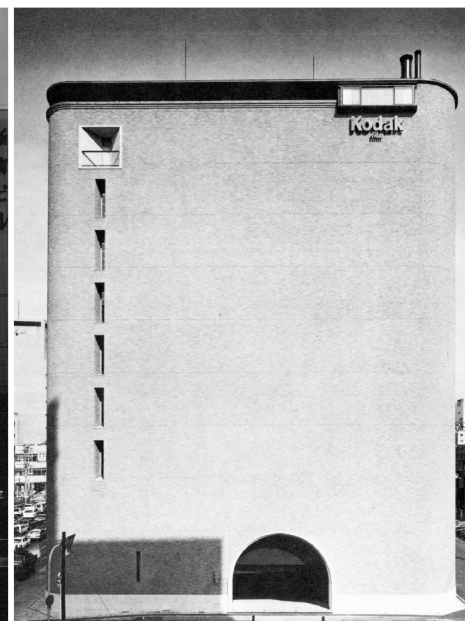

1980 KOBE SHOIN WOMAN'S UNIVERSITY KOBE CITY 26,700m²
BCS PRIZE by Japan Building Contractors

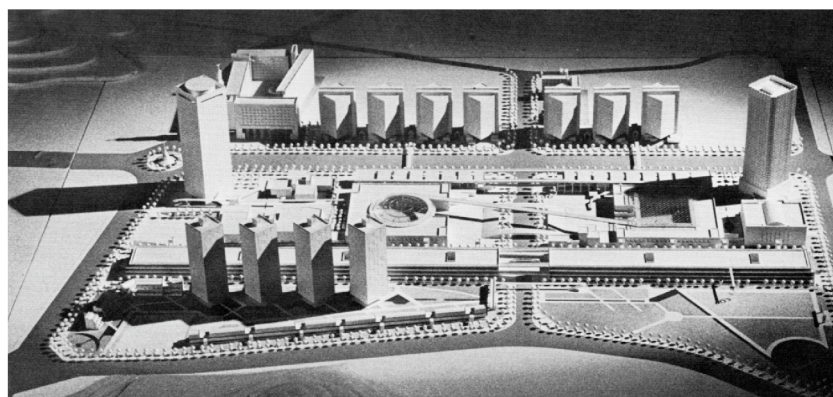

1982 Propozal for Special Economic Zone at ZUHAI, CHINA
Second Prize Winning

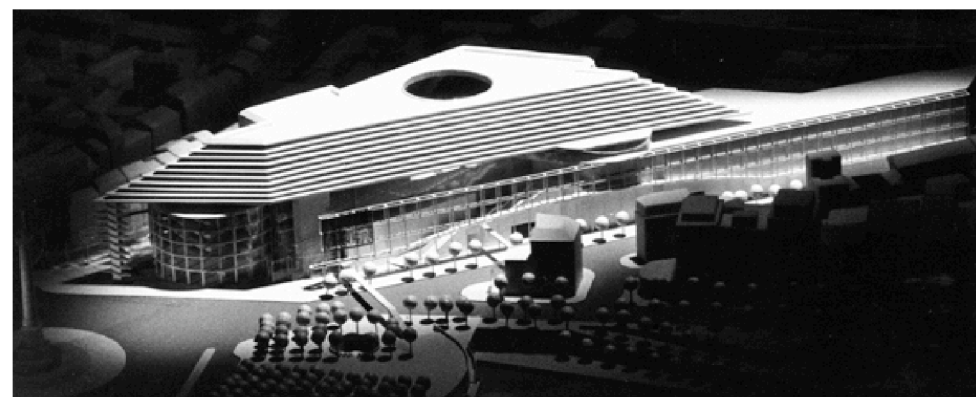

1982 Competition for L'Opera de BASTILL, PARIS
Third Prize Winning